

DHGL 32/400

HAFNER

Lineárne H vedenie pre valce ISO 15552 - gulôčkové ložisko



productDataPdf.propertiesHeader

| | |
|---------------------------|------------------------------|
| Priemer piestu | Ø32 |
| Zdvih | 400 mm |
| Materiál piestnice | Tvrdo chrómovaná oceľ (CK45) |

DHGL 32/400

HAFNER

Lineárne H vedenie pre valce ISO 15552 - gulôčkové ložisko

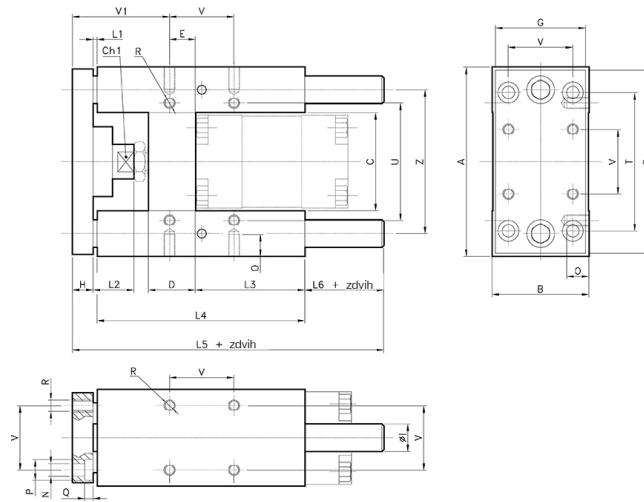

| Typ | Priemer piestu | A | B | C | Ch1 | D | E | F | G | H | ØI | L1 | L2 | L3 | L4 | L5 | L6 | N | O | P | Q | R | T | U | V | V1 | Z |
|--------------|-------------------|-----|-----|-------|-----|----|------|-----|-----|----|----|----|----|-----|-----|-----|----|-----|----|----|-----|---|-----|-----|------|------|-----|
| DHGL 32/... | Ø 32 | 97 | 49 | 51 | 15 | 24 | 4,3 | 93 | 45 | 12 | 12 | 25 | 42 | 75 | 125 | 187 | 25 | 6,6 | 12 | 11 | 6,5 | M | 78 | 61 | 32,5 | 82,7 | 74 |
| DHGL 40/... | Ø 40 | 115 | 58 | 58,2 | 15 | 28 | 11 | 112 | 55 | 12 | 16 | 25 | 42 | 80 | 140 | 207 | 30 | 6,6 | 12 | 11 | 6,5 | M | 84 | 69 | 38 | 86 | 87 |
| DHGL 50/... | Ø 50 | 137 | 70 | 70,2 | 20 | 34 | 18,8 | 134 | 65 | 15 | 20 | 25 | 50 | 78 | 148 | 223 | 35 | 9 | 16 | 15 | 8,5 | M | 100 | 85 | 46,5 | 91,2 | 104 |
| DHGL 63/... | Ø 63 | 152 | 85 | 85,2 | 20 | 34 | 15,3 | 147 | 80 | 15 | 20 | 25 | 50 | 106 | 178 | 243 | 25 | 9 | 16 | 15 | 9 | M | 105 | 100 | 56,5 | 96,7 | 119 |
| DHGL 80/... | Ø 80 | 189 | 105 | 105,5 | 26 | 50 | 25 | 180 | 100 | 20 | 25 | 25 | 50 | 111 | 195 | 267 | 27 | 11 | 20 | 18 | 11 | M | 130 | 130 | 72 | 104 | 148 |
| DHGL 100/... | Ø 100 | 213 | 130 | 130,5 | 26 | 55 | 30 | 206 | 120 | 20 | 25 | 25 | 50 | 128 | 218 | 290 | 27 | 11 | 20 | 18 | 11 | M | 150 | 150 | 89 | 105 | 173 |